

DUAL HEAD EMERGENCY LIGHT

UL US RoHS COMPLIANT CEC
DOE FC



Features:

- Injection-molded, flame-retardant, high-impact, thermoplastic housing.
- Self-test functions: Monthly test, Year test
- Innovative, easy installation in minutes
- Suitable for wall mount applications
- Universal J-box mounting pattern.
- 120V-277VAC Universal voltage operation.
- 2pcs 1W ultra bright 3030 SMT LED lamp heads for emergency mode..
- Built-in 3.6V 1000mAh Ni-MH battery for minimum 90 minutes emergency operation.(JLEU8-SD With self-test functions)
- Built-in 3.6V 2000mAh Ni-MH battery for minimum 90 minutes emergency operation.(JLEU8-RC, JLEU8-SD-RC, Remote capability up to 3W).
- Maximum 24 hours for full recharge time.
- Test switch and charge indicator.
- UL and cULus listed.
- 0" to 40 C indoor damp location listed.
- Three years warranty.

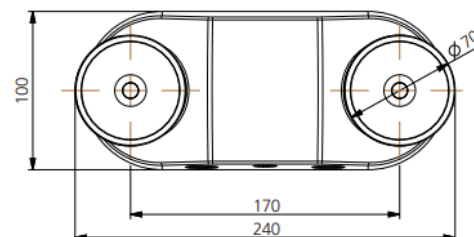
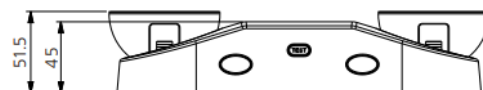

Ordering information

Model No.	Packing information	Options
JLEU8	36X25X22.5cm/12pcs 5/4kgs	Housing Color: White/Black
JLEU8RC	36X25X22.5cm/12pcs 7/6kgs	RC remote capability
JLEU8-SD	36X25X22.5CM/12pcs 5/4kgs	SD self-test functions
JLEU8-SD-RC	36X25X22.5CM/12pcs 7/6kgs	